

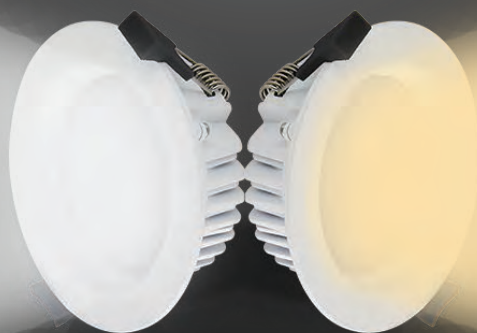

LED LIGHT **Intelligent Control**





An overview of the 2.4G wireless dimming and color changeable system

Diagram for the whole system

This system is a high performance LED 2.4G+WIFI wireless dimmable and color changeable function product, mainly used on all kinds of LED light which need to be dimmable and color changeable, such as Led bulb, Led ceiling light, Led down light, led panel light, etc. The remote-controller can control the led lights directly, and also can send control signals by mobile phone APP to the WIFI Box to control the led lights, the free grouping function, flexible and convenient operation, gives you a new feeling never experienced before.

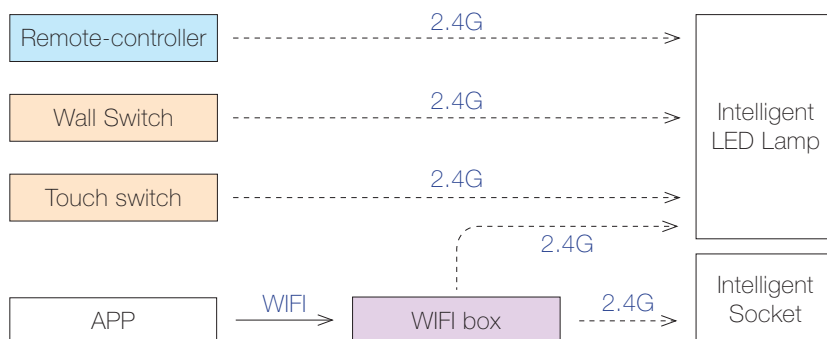

Remote controller



Wireless wall touch switch



WIFI Box
(Mobile App)

Function of keys

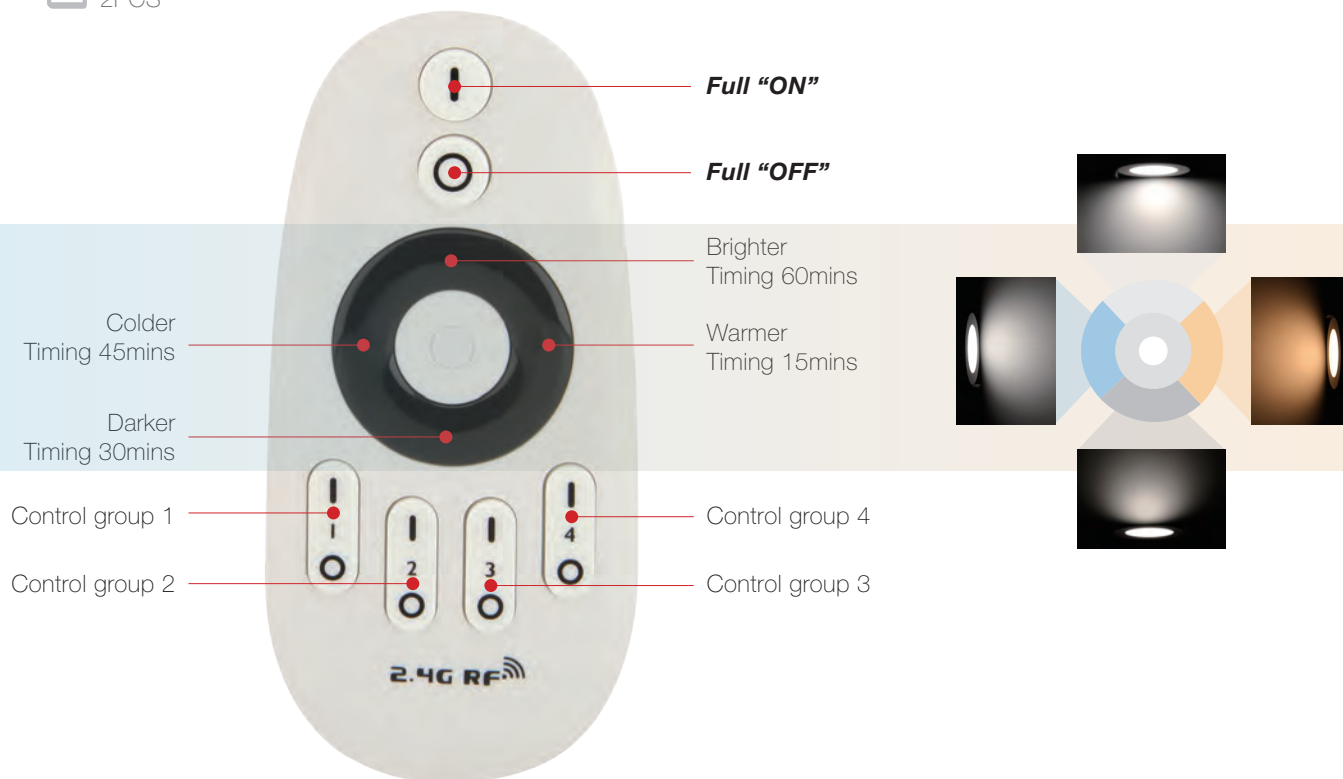

Remote-controller parameters

Power supply: 3V (two AAA 7# battery)
Radio frequency: 2400MHz~2483.5MHz
Modulation Mode: GFSK
Emission power: 6dBm
Standby power consumption: 5μA
Telecontrol distance: 20m~30m
Dimension: 103.8mmx40mmx25mm



Dimmable



Color
Changeable



Timing



Memory



Distance
30m

The Remote Control Operation Instruction

Features and functions

Code Matching and grouping: (only they are code matched with each other can the lamp be controlled remotely)

- Select the lamp need to be conducted with grouping control; after turning off the power for 10 seconds, turn on the power again; in this moment (within 3 seconds), press the "Group On" button (); the lamp will flash for 3 times to confirm the matching and grouping is done.
- Repeat the steps above until all the lamps are matched and grouped.
- Only after this step, the function as below can be set up (color control, light control, timing and night lamp).



Clear code and Re-grouping: (disconnect the led lamp and remote controller to cancel the remote control)

- Cut off the power supply for 10 seconds and switch on again, at the moment it's switched on, press "group on" button () 5 times in a row, then the lamp with quick flashing 6 times which predict the success of code cleaning.
- Repeat the step of group code matching can work for LED lights again.

Synchronous and Re-grouping control: (for light dimming and colour changeable)

- Synchronous Press Full "ON" button () enter into Synchronous set mode, press each function button to control all group of LED lamp processing light dimming, colour changeable, timing and night lamp function at the same time.
- Re-grouping Press "group on" button () enter into re-grouping set mode, press each function button to control LED lamp in one single group processing light dimming, colour changeable, timing and night lamp function at the same time.

Turn-off timing function:

- With keeping normal power "on" position, long-press full "ON" button (). After the lamp's quick flashing, press the timing length button within 3 seconds, then the lamp will flash 1-4 times in line with duration which predict the timing success.
- To cancel the timing function, press full "OFF" button () first, then turn them back on.

Night lamp function:

- With keeping normal power on, long-press full "OFF" button () at least 2 seconds, the corresponding LED lamp enters night light mode, the light brightness can reach at 2% of the maximum brightness.
- Press any button on this remote controller can exit from this mode.

Grouping control: (remote controller makes several-for -one or one-for-several control possible with LED lamp)

- Keep the original mode, Cut off the power supply for 10 seconds and switch on again, use another remote controller operating grouping code within 3 seconds. Then the LED lamp sets can be controlled by other remote controller.
- Cut off the power supply for 10 seconds and switch on again, use same remote controller operating grouping code within 3 seconds. Then different group of LED lamp sets can be controlled by same remote controller.

Memory Function:

- The lamp will be the same brightness and color when it's on after power off or it's turned off.

2.4G RF Wireless wall touch switch

Function of keys

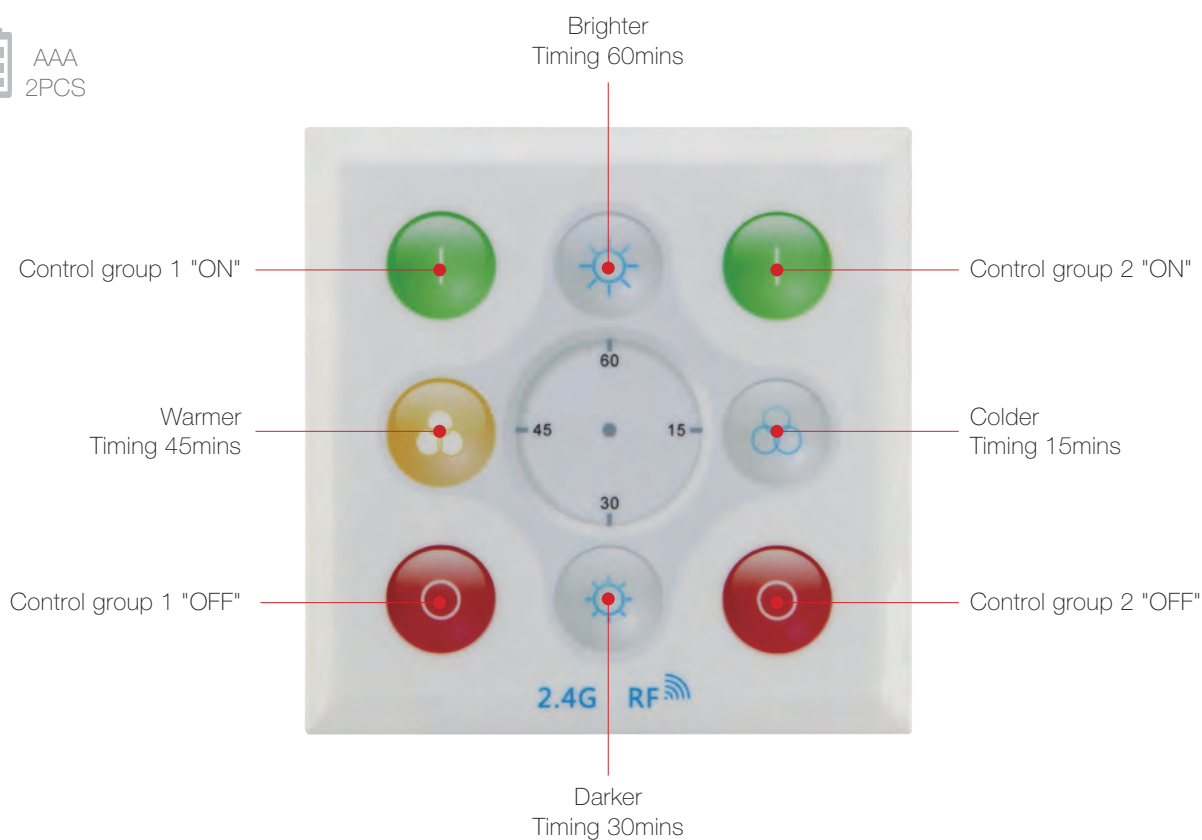

Wireless Wall Touch Switch parameters

Power Voltage: 3V (two AAA 7# battery)

Transmitting: 2400MHz~2483.5MHz

Transmitting power factor frequency: 6dBm

Standby power consumption: 5μA

Touch mode: Capacitive Touch

Control distance: 20m~30m

Dimension: 109mm×53mm×22mm

Material: imported PC

Standby time: 90 days



Dimmable



Color
Changeable



Timing



Memory



Distance
30m

Operation Instruction

Features and functions

Code Matching and grouping: (Only they are code matched with each other can the lamp be controlled remotely)



- Select the lamp need to be conducted with grouping control; after turning off the power for 10 seconds, turn on the power again; in this moment (within 3 seconds), press the group "ON" button (); the lamp will flash for 3 times to confirm the matching and grouping is done.
- Repeat the steps above until all the lamps are matched and grouped.

Only after this step, the function as below can be set up (color control, light control, timing and night lamp).

Clear code and Re-grouping: (disconnect the led lamp and remote controller to cancel the remote control)

- Cut off the power supply for 10 seconds and switch on again, at the moment it's switched on, press group "ON" button () 5 times in a row, then the lamp with quick flashing 6 times which predict the success of code cleaning.
- repeat the step of group code matching can work for LED lights again.

Turn-off timing function:

- Long press group "ON" button (). After the lamp's quick flashing, press the timing length button within 3 seconds, then the lamp will flash 1-4 times in line with duration which predict the timing success.
- To cancel the timing function, press group "OFF" button () first, then turn them back on.

Night lamp function:

- Long press group "OFF" button () at least 2 seconds, the corresponding LED lamp enters night light mode, the light brightness can reach at 2% of the maximum brightness.
- Press any button on this remote controller can exit from this mode.

Grouping control: (wall switch makes several-for -one or one-for-several control possible with LED lamp)

- Keep the original mode, Cut off the power supply for 10 seconds and switch on again, use another wall switch operating grouping code within 3 seconds. Then the LED lamp sets can be controlled by other wall switches.
- Cut off the power supply for 10 seconds and switch on again, use same wall switch operating grouping code within 3 seconds. Then different group of LED lamp sets can be controlled by same wall switch.

Memory Function:

- The lamp will be the same brightness and color when it's on after power off or it's turned off.

WIFI Box instructions

smart wifi box is equivalent to a signal transfer device, the mobile phone of instruction, after the transfer to lamps and lanterns, the control system for the lamps and lanterns, without complex operation, not here to do detailed introduction.



WIFI Box parameters

Power Voltage: AC200-240V

Working temperature: -20°C~45°C

Relative humidity: 10%~93%

Remote control distance: 30m

Remote control frequency: 2.4G

Product size: 110mmx65mmx45mm

Remote controllable by mobile APP



Dimmable



Color
Changeable



Timing



Distance
30m

Operation Instruction

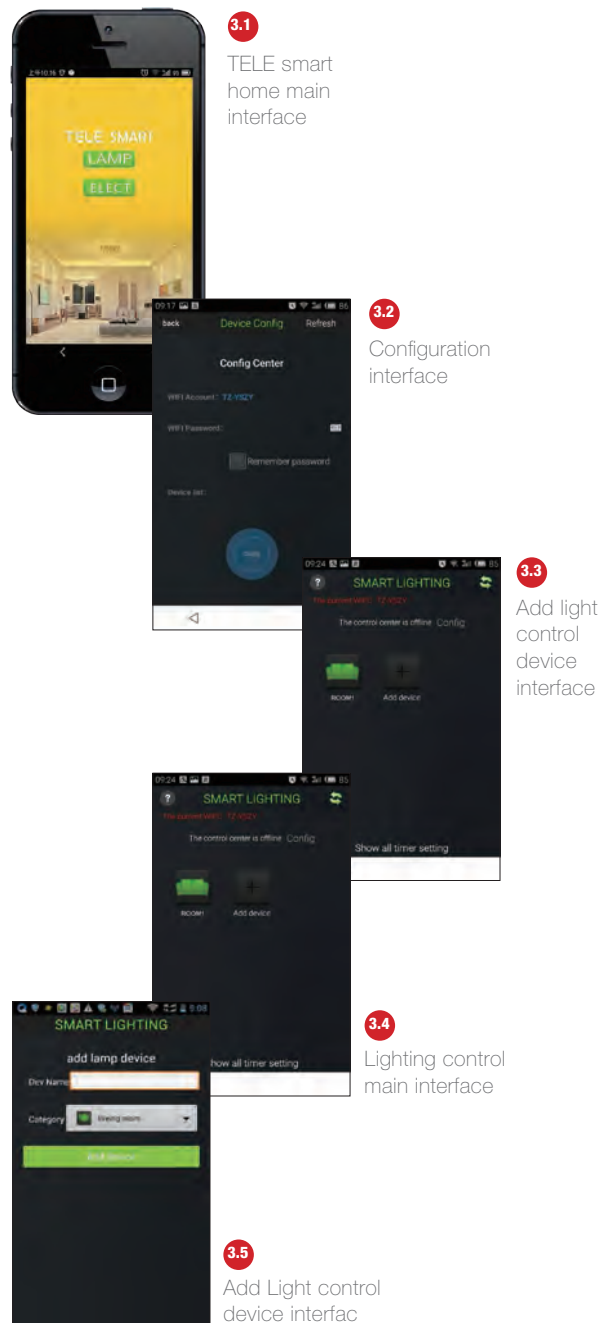

APP instructions

- Smart wifi box through the ac adapter connected to 85V~265VAC 50/60Hz, at the instant of the connected flash control box of the green light to red light bright. Said control box is in good working condition, in the back of the operation as long as the APP has a green light will flash, in the process of entering the mobile phone or tablet WIFI Settings interface, open the WIFI, ensure that mobile phones and the router is WIFI connection, smart wifi box of the device ID number in the list of WIFI also.
- Click smart APP icon into the intelligent household main interface (as shown in figure 3.1), using click lighting control for the first time into the configuration interface (as shown in figure 3.2), and choose the WIFI name and corresponding WIFI password input binding smart wifi box (note ID number after the equipment list, as shown in figure 3.2), click on the circular configuration icon, the system began to automatic configuration (configuration progress bar start action), the configuration about within 30 seconds to complete.
- After the success of the configuration to jump to lighting control main interface (as shown in figure 3.3), click on the interface (as shown in figure 3.3) at the bottom of the add button (at this point is gray), add the equipment into the interface (as shown in figure 3.5), fill in the equipment number, name, select the icon, press sure add success, after the success of the add icon into a green, automatically return to the main interface, repeat this step in figure 3.4 the main interface to add multiple devices.

Operation Instruction

- Click on the home screen icon (as shown in figure 3.4) the sitting room, can enter the light color temperature control interface (as shown in figure 3.6) or RGB control interface (as shown in figure 3.7), the default interface for light color temperature control interface, click in the top right corner of the icon you can switch between the two interfaces.
- To the yard operation: the living room lights, for example, the sitting room light without electricity for at least 10 seconds, again on the electric 3 seconds press the light color temperature control interface (as shown in figure 3.6) turn on the light above the key, the sitting room light slow flash 3, said the code is successful, so RGB lamp, please in the visual control interface (as shown in figure 3.7) to the code, the code method, repeat this step to complete other lights on code; Fingers sliding brightness, color temperature, or ribbon can control corresponding to the lamp brightness, color temperature, or color, click the switch button, can control the corresponding destroy the light of lamp; Four buttons can also click on the bottom of the screen directly into the default scene mode.
- According to the color temperature light / RGB control interface timing set key, enter the time setting main interface (as shown in figure 3.8) choose the right time, date, according to determine the complete set the time switch.
- Editing features: living room lights, for example, according to the main interface sitting room lights icon for 2 seconds long, at the bottom of the pop-up editing interface (as shown in figure 3.9), and to edit the equipment number, name, icon, you can enter the time setting, here can also delete the equipment.

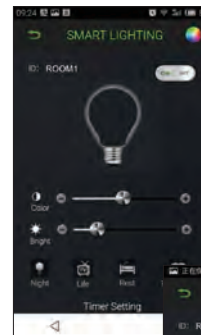

3.6
Color temperature control interface



3.7
RGB control interface



3.8
Timer setting interface

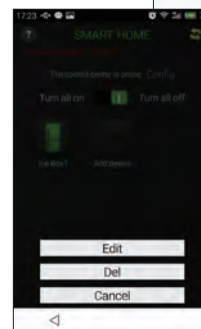

3.9
Editing interface

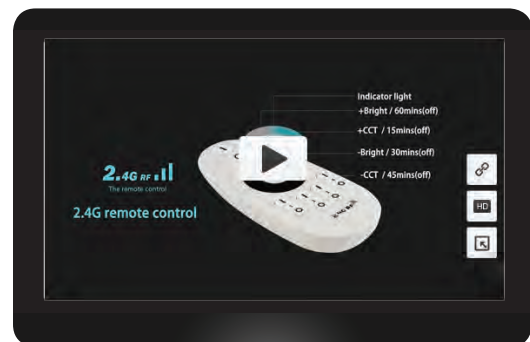

Want more information, please visit

[Upshinelighting](#) @ [YouTube](#)

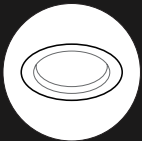

Downlight
series



Panel light
series



Track light
series

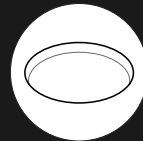

Ceiling light
series

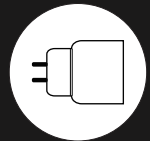

Tube light
series

New upgrade, New website

More Products, Please click upshine.com



2nd building
Dingfeng High-Tech Zone,
Fuyuan 1st road,
Fuyong Sub-district,
Bao'an, Shenzhen China

Tel: +86-755-29197332

Fax: +86-755-29197301

E-mail: info@upshine-lighting.com

Web: www.upshine.com

Zip code: 518103

