



UPSHINE®



Technical Application
Guide for UP SHINE
LED Track Light

UP-TL26A-20W

Introduction



Up-shine track light adopts Citizen LEDs with excellent color rendering index to increase the color fidelity of the target illuminated object. It provides excellent heat dissipation and even light output without glare or dark spot. Adjustable lighting orientation with 360 degree in horizontal direction and 350 in vertical direction provided. 1-circuit adapter, 3-circuit adapter are all available.

- Up to 70% energy saving compared to standard CFL
- Long lifetime of 40,000 hours
- 15° 24° 36° 60° beam angle
- CCT: 2700K 3000K
4000K 5000K
- No UV/IR light
- Environment friendly, without Mercury or any other hazardous substances

Application notes

- IP20 for indoor use only
- Professional electrician for installation only
- Switch off before installation
- Do not touch when in use
- Keep away from hot steam and corrosive gas

Application Areas

It is suitable for supermarket, specialty store, show window, exhibition hall, focus lighting, decorative and background lighting, where attention is focused on subjects to emphasize special visual points.

Certificate

CE **RoHS**



Product Information

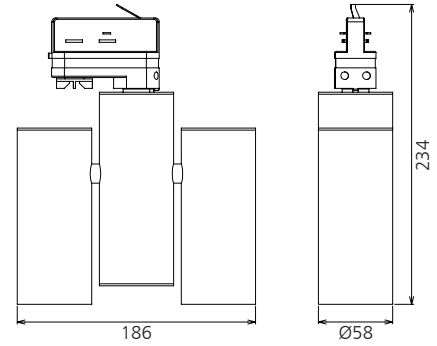

Technical Specifications

Model	Voltage	Power	Power Factor	Lumen (± 10%)	Beam angle	CCT	Lifespan	CRI	Dimmable	Dimension
UP-TL26A-20W	AC230V	20W	≥0.9	1340	15°/24°/36°/60°	2700K	40000h	≥80	No	186*234mm
UP-TL26A-20W	AC230V	20W	≥0.9	1400	15°/24°/36°/60°	3000K	40000h	≥80	No	186*234mm
UP-TL26A-20W	AC230V	20W	≥0.9	1460	15°/24°/36°/60°	4000K	40000h	≥80	No	186*234mm
UP-TL26A-20W	AC230V	20W	≥0.9	1500	15°/24°/36°/60°	5000K	40000h	≥80	No	186*234mm
UP-TL26A-20W-D	AC230V	20W	≥0.9	1260	15°/24°/36°/60°	2700K	40000h	≥80	Yes	186*234mm
UP-TL26A-20W-D	AC230V	20W	≥0.9	1320	15°/24°/36°/60°	3000K	40000h	≥80	Yes	186*234mm
UP-TL26A-20W-D	AC230V	20W	≥0.9	1360	15°/24°/36°/60°	4000K	40000h	≥80	Yes	186*234mm
UP-TL26A-20W-D	AC230V	20W	≥0.9	1400	15°/24°/36°/60°	5000K	40000h	≥80	Yes	186*234mm

Driver data Sheet

Driver data	DIM	Non dim
Input rated Voltage	AC230V	AC230V
Frequency	50Hz	50Hz
Input Voltage	AC200-240V	AC200-240V
Efficiency	≥83%	≥85%
Total load Wattage	20W±1W	20W±1W
Power Factor	≥0.9	≥0.9
Rated input current	≤0.12A	≤0.12A
Full load output Voltage	DC23-40V	DC24-40V
Rated output current	500mA	500mA
Output current range	500mA±5%	500mA±5%
Power tolerance	±5%	±5%
Current output tolerance	±5%	±5%
Dimming range	8%-100%	—
Dimmer	Triac dimmers	—
Short circuit protection	PASS	PASS
Over voltage protection	PASS	PASS
Over temperature protection	PASS	PASS
THD	≤18%	≤18%
Withstand voltage	AC1500V	AC1500V

Fixture Compatibility

Rated Wattage	Electrical Classification	Ingress Protection	Operating Temp	Operating Humidity	Storage Temp
20W	I	IP20	-20°C~45°C	0~90%	-20°C~65°C

Spectral Distribution

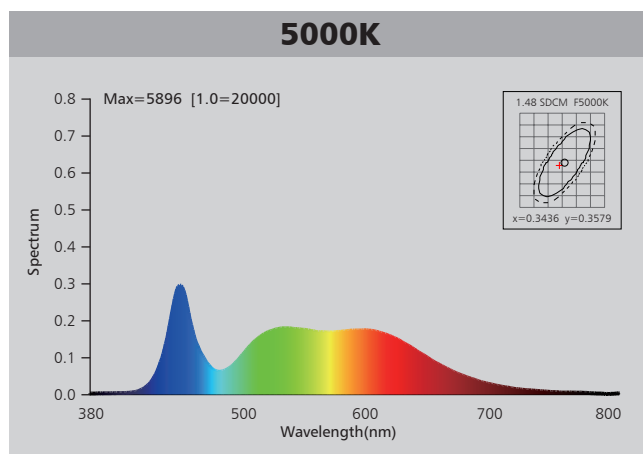
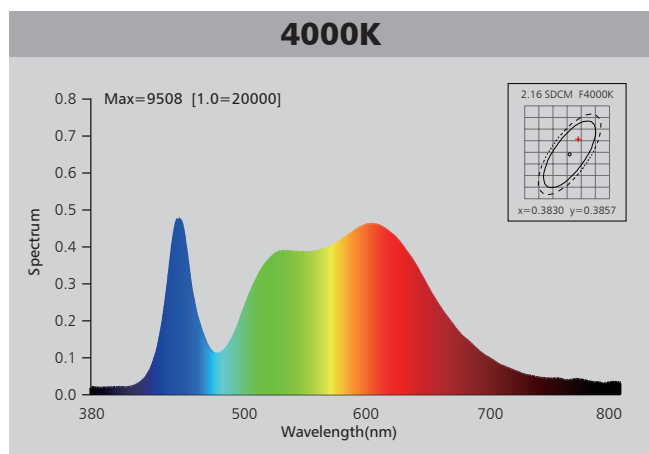
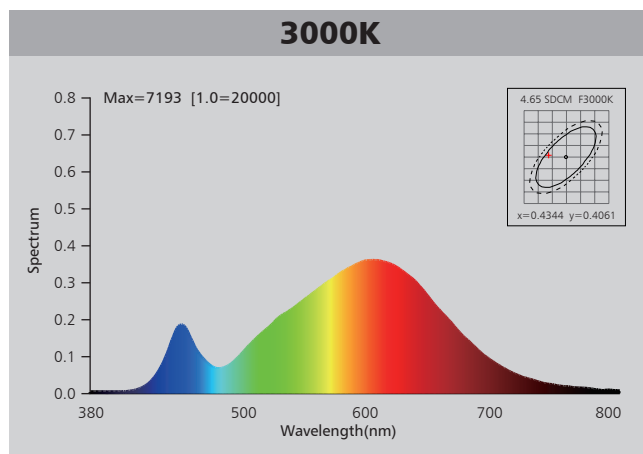
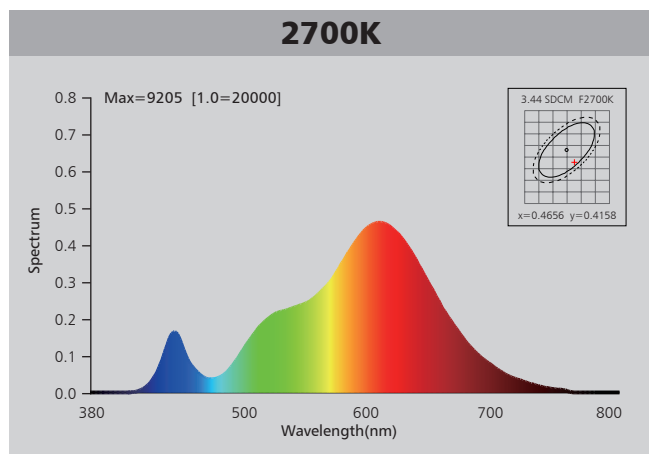

Photometric Diagram

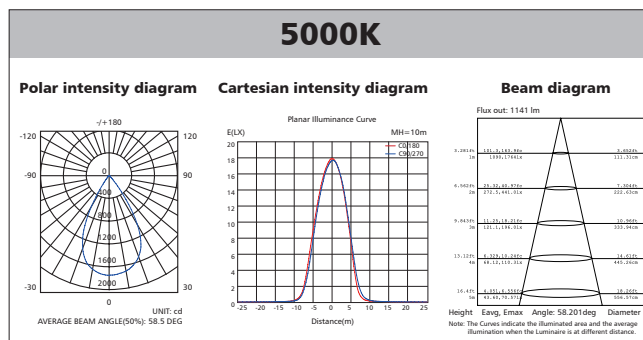
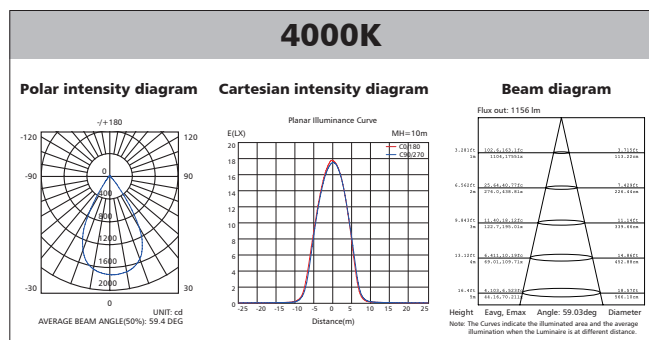
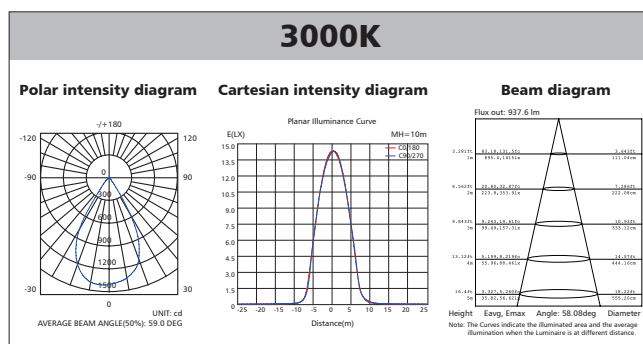
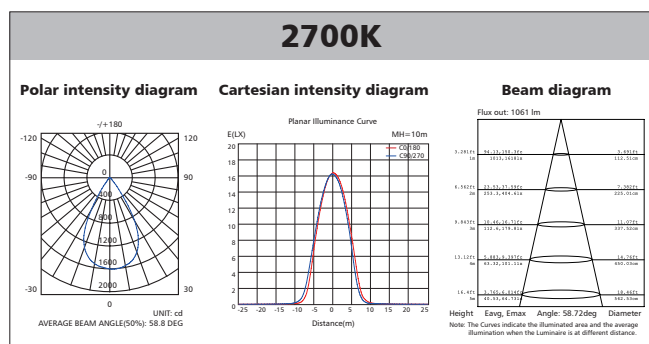

Polar Diagram Comparison

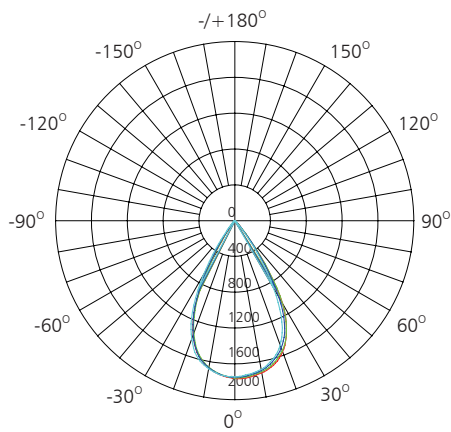

UNIT: cd

- C0/180, 58.7 deg
- C30/210, 58.8 deg
- C60/240, 58.4 deg
- C90/270, 58.2 deg

AVERAGE BEAM ANGLE (50%): 58.5DEG



Driver lifetime & LED light decay rate

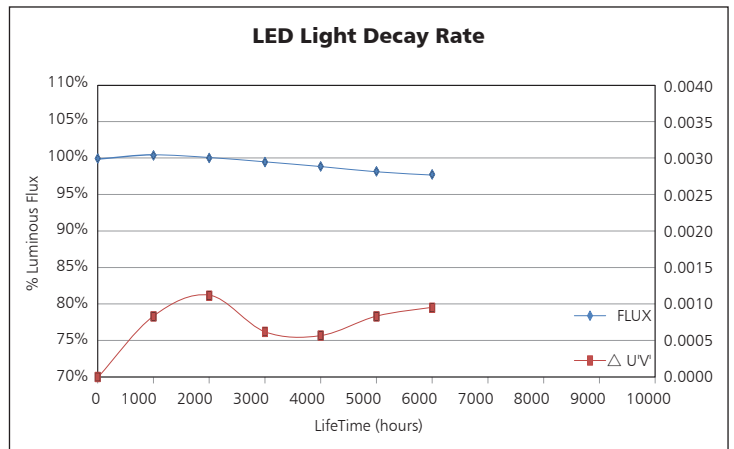
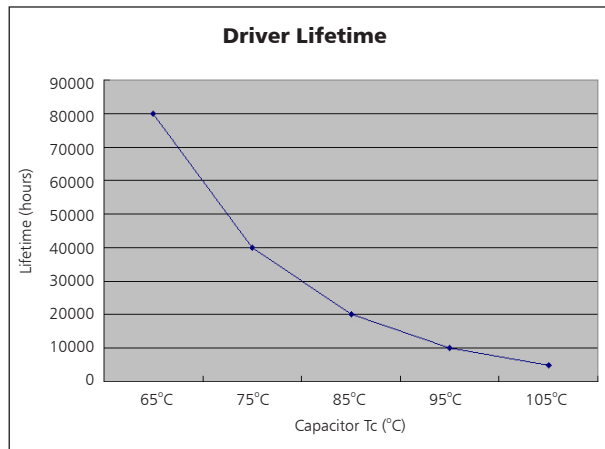

Temperature

- The testing is operated at 25°C
- The lifetime of capacitor, minimum of 5,000 hours if operated at 105°C, will be doubled whenever the temperature drops 10°C.
- The highest withstand temperature of IC, MOS could be 120°C
- The highest withstand temperature of LED junction temperature is 150°C

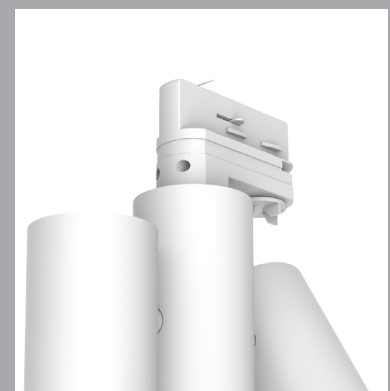
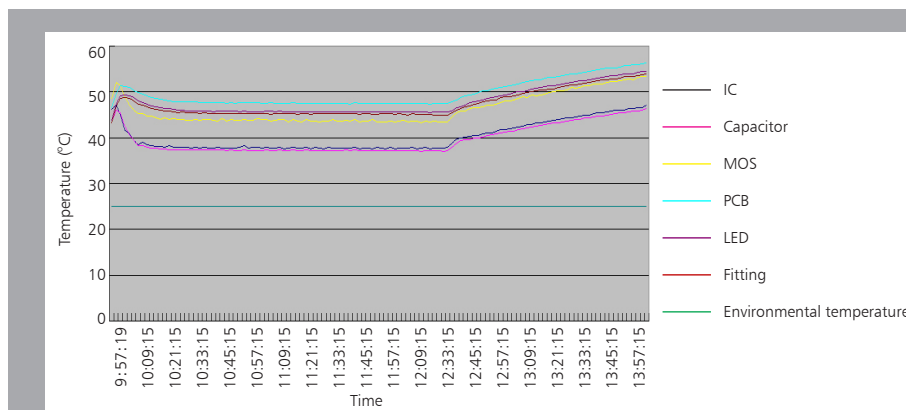

The driver lifespan is based on capacitor working temperature.

Installation Procedure

WARNING

1. Switch off before installation.
2. Switch on only after complete installation and examination of the circuit.
3. Professional electrician for installation and maintenance only.

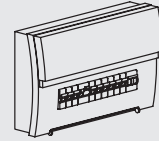

**Turn Off
Power Supply**

Step 1

Turn Off power supply before starting any installation. Read instructions & check you have all the tools & accessories to complete the installation correctly.

Step 2

Prior to locating Adaptor into Track Section make sure it is set in the 'OFF' position & 'Locking Lever' is set in the position shown.

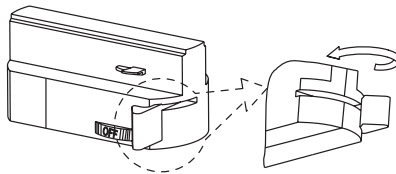

2-wires, 3-wires adaptor

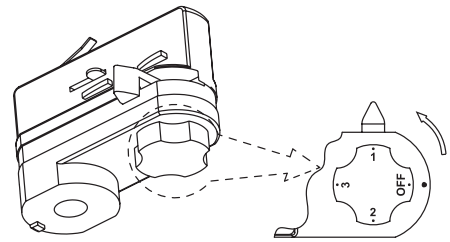

4-wires adaptor

Step 3

Locate Track Adaptor into Track Section (1) & lock into position by turning 'Locking Lever' 90°(2)

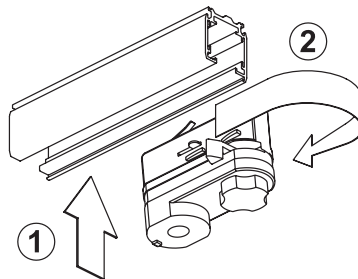

2-wires, 3-wires control luminaires in same circuit by ON/OFF switch.

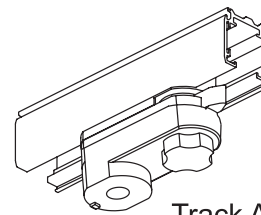

Track Section

Track Adaptor shown locked into Track Section

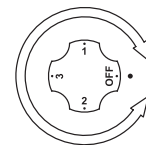
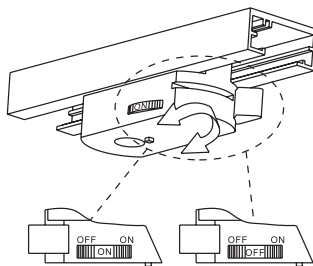

4-wires Turn clockwise or anti-clockwise.

Packaging Information

	SIZE(CM)	N.W/pc (KGS)	G.W.(KGS)	QTY(PCS)
Carton	53.5*50*46.5	0.9	21	20

	CTNS	Q'TY(PCS)	VOLUME(CBM)
20" standard container	223	4460	28
40" standard container	446	8920	56

