

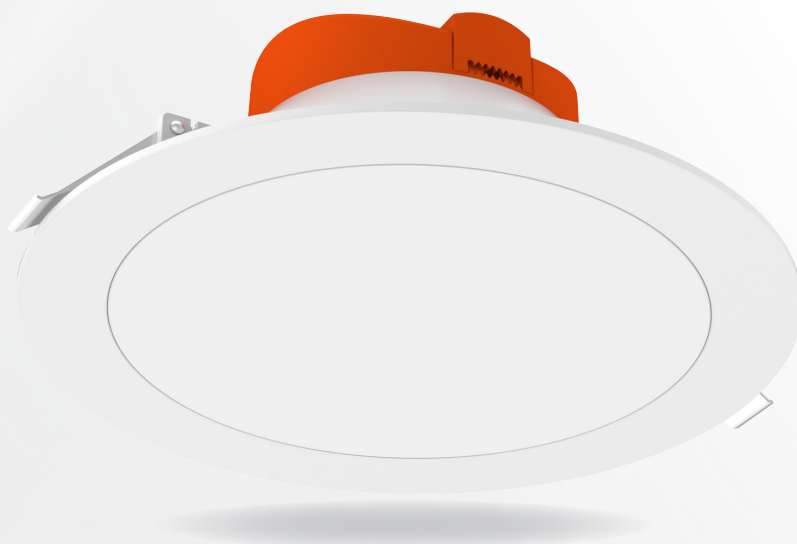

UPSHINE®



Technical Application Guide for UP-SHINE LED Downlight

UP-DL41-8-20W-P3



Introduction

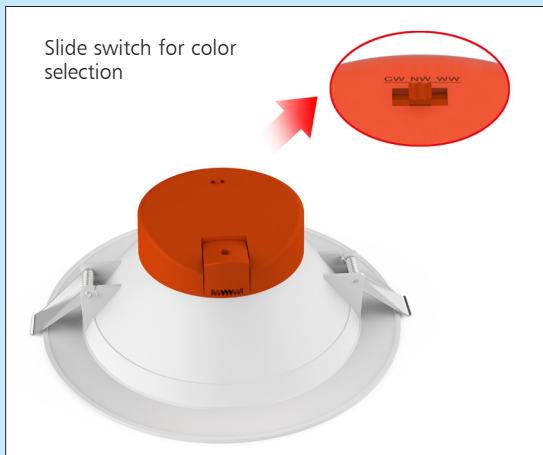
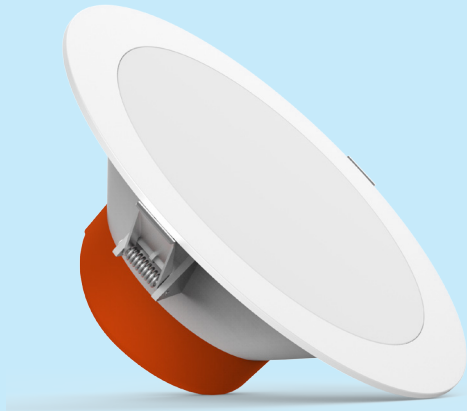

Up-shine SMD LED Down light adopts high lumen SMD LED, PC diffuser with even light output. Plastic coated aluminum housing with internal driver design; it is our most economical and practical downlight version. Dimmable driver shares great popularity by the excellent dimming effect.

- Up to 70% energy saving compared to standard CFL
- Long lifetime of 40,000 hours
- Dimmable when using triac dimmer
- 90° wide beam angle
- 200-210mm cutout
- CCT: 3000K 4000K 5700K
- No UV/IR light
- Environment friendly, without Mercury or any other hazardous substances
- Internal Driver

Application notes

- IP20 for indoor use only
- Professional electrician for installation only
- Switch off before installation
- Do not touch when in use
- Keep away from hot steam and corrosive gas

Application Areas

It is designed for general lighting applications in office, supermarket, shop, school, hotel, etc. It is also widely used for public areas, such as stairway, lobby, reception, corridors etc.

Certificate



Product Information

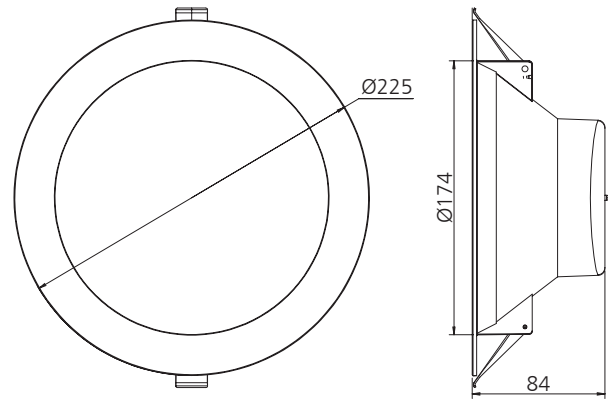

Technical Specifications

Model	Voltage	Power	Power Factor	Lumen (±5%)	Beam angle	CCT	Lifespan	CRI	Dimmable	Dimension
UP-DL41-8-20W-P3	AC230V	20W	0.9	1820	90°	3000K	40000h	≥80	Yes	Ø225*84mm cutout 200-210mm
UP-DL41-8-20W-P3	AC230V	20W	0.9	2200	90°	4000K	40000h	≥80	Yes	Ø225*84mm cutout 200-210mm
UP-DL41-8-20W-P3	AC230V	20W	0.9	1960	90°	5700K	40000h	≥80	Yes	Ø225*84mm cutout 200-210mm

Driver data Sheet

Driver data	DIM
Input rated Voltage	AC230V
Frequency	50Hz
Input Voltage	AC200-240V
Efficiency	≥86%
Total load Wattage	20W±5%
Power Factor	0.9
Rated input current	≤0.12A
Full load output Voltage	65-78V
Rated output current	240mA
Output current range	240mA±5%
Power tolerance	±5%
Current output tolerance	±5%
Dimming range	8%-100%
Dimmer	Triac dimmers
Short circuit protection	PASS
Over voltage protection	PASS
Over temperature protection	PASS
Withstand voltage	—

Fixture Compatibility

Rated Wattage	Electrical Classification	Ingress Protection	Operating Temp	Operating Humidity	Storage Temp
20W	II	IP20	-20°C~45°C	0~90%	-20°C~65°C

Spectral Distribution

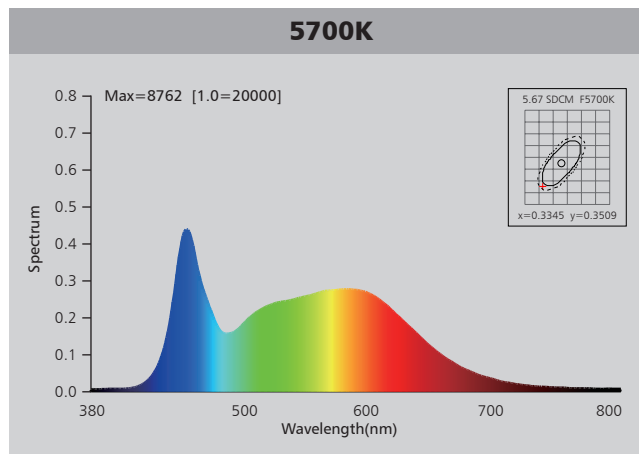
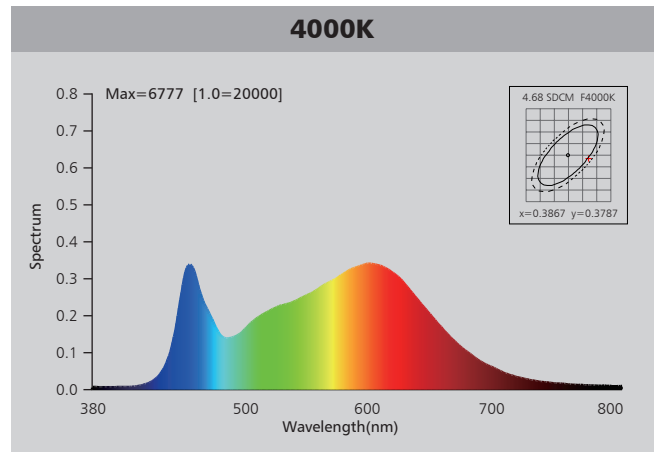
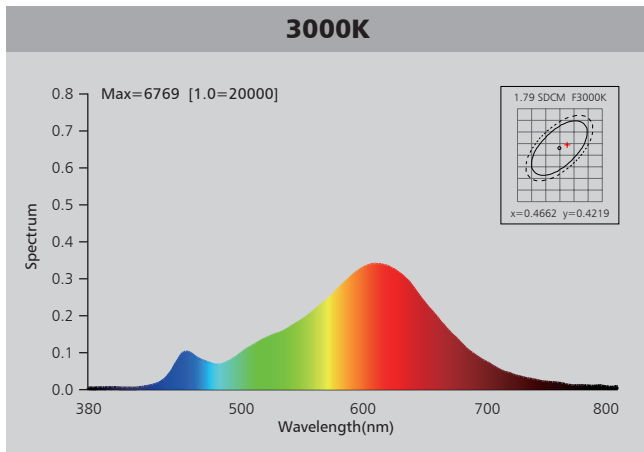

Photometric Diagram

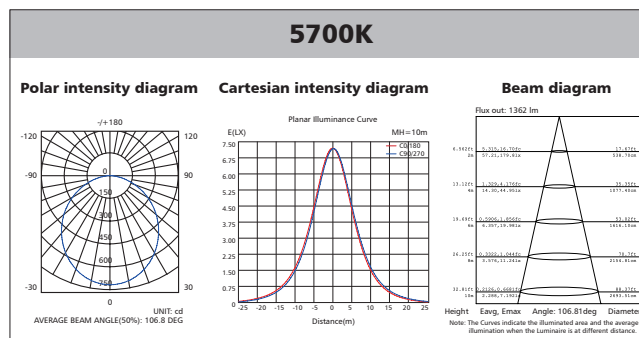
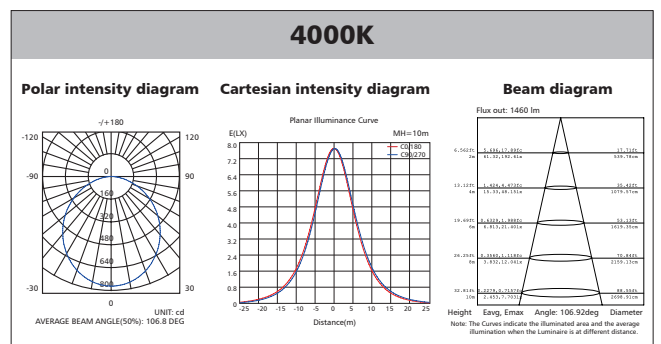
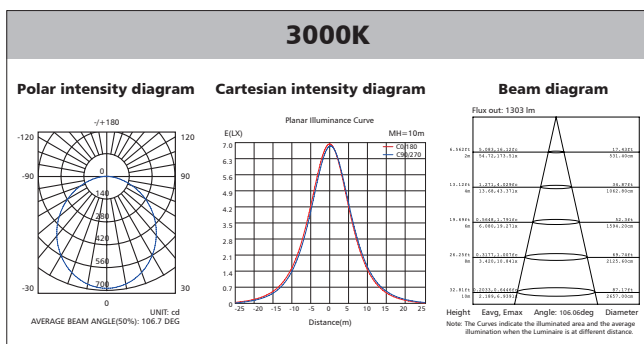

Polar Diagram Comparison

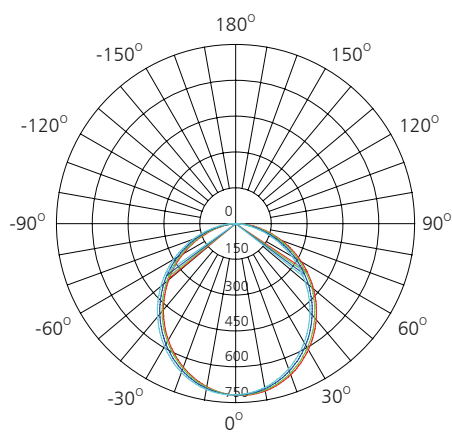

UNIT: cd

- C0/180, 106.8 deg
- C30/210, 106.8 deg
- C60/240, 106.8 deg
- C90/270, 106.8 deg



AVERAGE BEAM ANGLE (50%): 106.8DEG

Driver lifetime & LED light decay rate

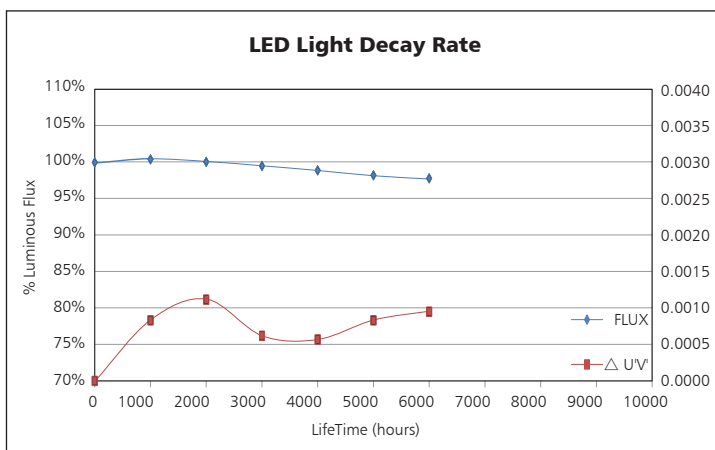
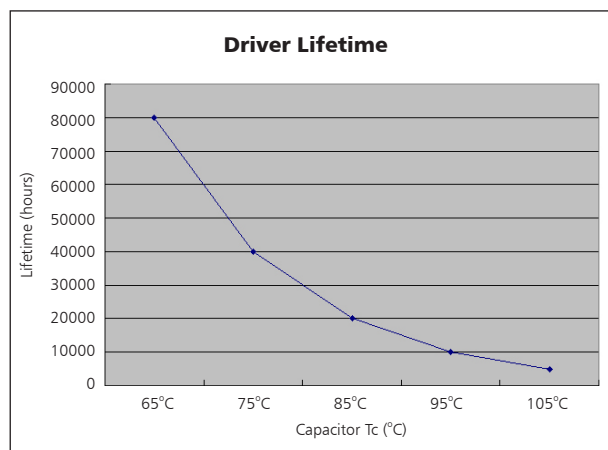

Temperature

- The testing is operated at 25°C
- The lifetime of capacitor, minimum of 5,000 hours if operated at 105°C, will be doubled whenever the temperature drops 10°C
- The highest withstand temperature of IC, MOS could be 120°C
- The highest withstand temperature of LED junction temperature is 150°C

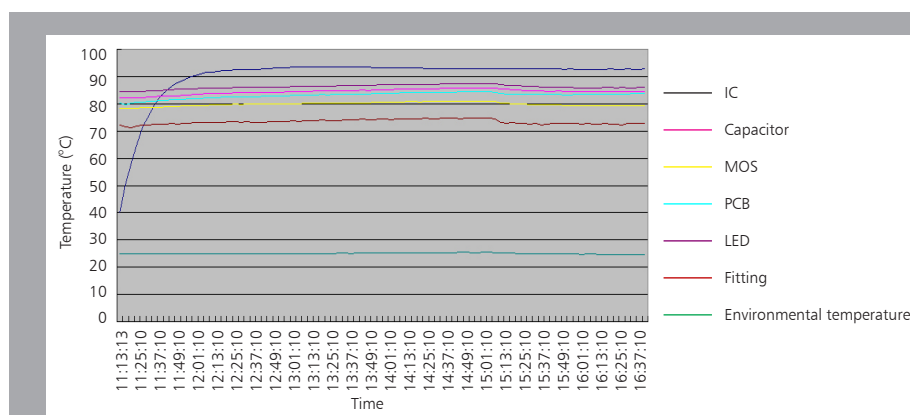

The driver lifespan is based on capacitor working temperature.

Installation

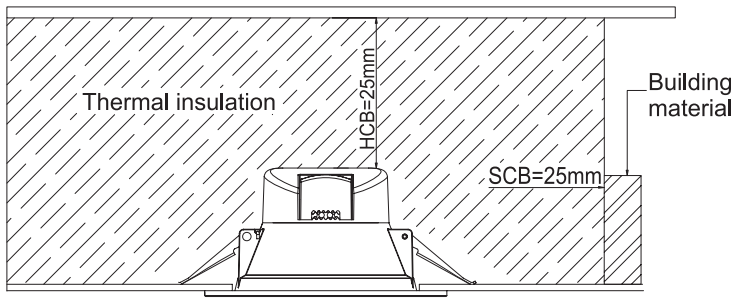

<p>Ceiling Opening</p> <p>1</p>	<p>Loosen the screw and take off the cover, connect the wire to the wiring terminals, put the cover back and tighten the screw.</p> <p>2</p>
<p>A. Hold back spring clips</p> <p>B. Push downlight into position</p> <p>3</p>	<p>Spring Clips</p> <p>Ceiling</p> <p>4</p>

Packaging Information

	SIZE(CM)	N.W/pc (KGS)	G.W.(KGS)	Q'TY(PCS)
Carton	48*48*49	0.635	14	20

	CTNS	Q'TY(PCS)	VOLUME(CBM)
20" standard container	245	4900	28
40" standard container	490	8900	56

